

Instructions for use RAY Knee Holder for Distal Femoral Osteotomy Training

SYNBONE
better education outcome

Optional set up to RAY Knee Holder System for Distal Femoral Osteotomy (DFO) Training



The RAY Knee Holder System can optionally also be used for DFO training



0027.35 RAY Knee Holder adapter set for DFO training



LD2172 Femur malformation notch with mounted adapter set 0027.35



Remove the standard notch holders from the brackets

Adjustment



Insert the first DFO adapter into the hole of the femur bone model



Insert the second DFO adapter into the notch of the femur bone model



Insert the DFO adapter to the bracket of the guiding rail and tighten the locking lever with slight pressure



Insert the DFO adapter to the bracket of the supporting column and tighten the locking lever with slight pressure



The RAY Knee Holder can now be used for DFO training

Distal Femoral Osteotomy (DFO) Training

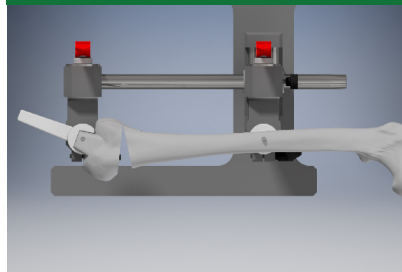

Visualisation of closed wedge technique training with RAY Knee Holder System

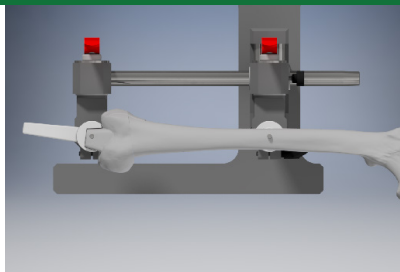

Visualisation of closed wedge technique training with RAY Knee Holder System

Contact us

SYNBONE AG

Tardisstrasse 199
7205 Zizers · Switzerland
Phone +41 81 300 02 80
sales@synbone.com
www.synbone.com

SYNBONE SDN BHD

No. 40 - 41, Jalan i-Park 1/3
81000 Bandar Indahpura Kulai, Johor · Malaysia
Phone +60 766 082 20
sales@synbone.com
www.synbone.com

Instructions for use RAY Knee Holder for High Tibial Osteotomy Training

SYNBONE
better education outcome

Optional set up to RAY Knee Holder System for High Tibial Osteotomy (HTO) Training



The RAY Knee Holder System can optionally also be used for HTO training



0027.30 RAY Knee Holder adapter set for HTO training



LD1175 Tibia malformation notch with Fibula with mounted adapter set 0027.30



LD1173 Tibia malformation notch with mounted adapter set 0027.30



Remove the standard notch holders from the brackets

Adjustment

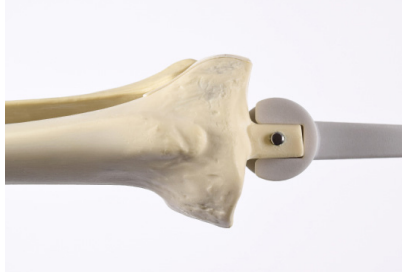

Insert the first HTO adapter into the notch of the tibia bone model



Insert the second HTO adapter into the hole of the tibia bone model

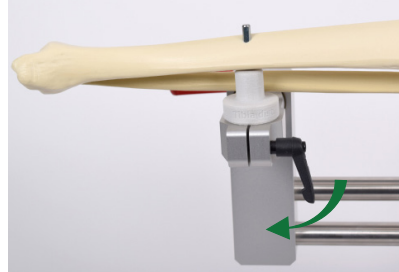

Insert the HTO adapter to the bracket of the guiding rail and tighten the locking lever with slight pressure

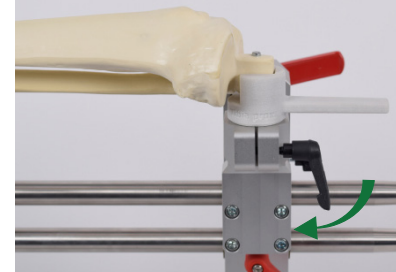

Insert the HTO adapter to the bracket of the supporting column and tighten the locking lever with slight pressure



The RAY Knee Holder can now be used for HTO training

High Tibial Osteotomy (HTO) Training

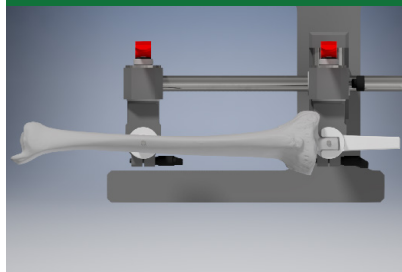

Visualisation of open wedge technique training with RAY Knee Holder System

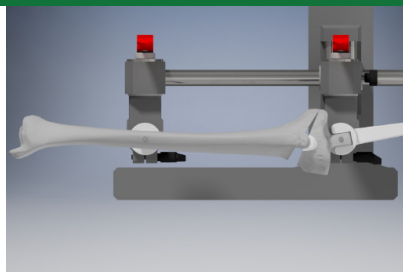

Visualisation of open wedge technique training with RAY Knee Holder System

Contact us

SYNBONE AG

Tardisstrasse 199
7205 Zizers · Switzerland
Phone +41 81 300 02 80
sales@synbone.com
www.synbone.com

SYNBONE SDN BHD

No. 40 - 41, Jalan i-Park 1/3
81000 Bandar Indahpura Kulai, Johor · Malaysia
Phone +60 766 082 20
sales@synbone.com
www.synbone.com